

English

Quick Start

Connecting to a Computer

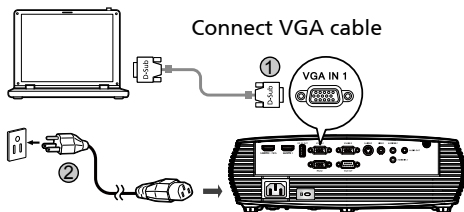

Connect VGA cable

Connect power cord

Powering On the Projector

Turn on the projector and computer

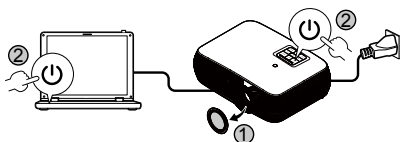

Remove the lens cap

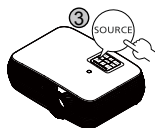

Select the input source

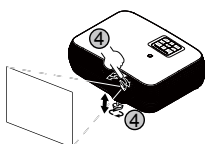

Adjust focus or zoom

Powering Off the Projector

Press the power button twice.

Bahasa Indonesia

Memulai dengan Cepat

Menyambung ke Sumber

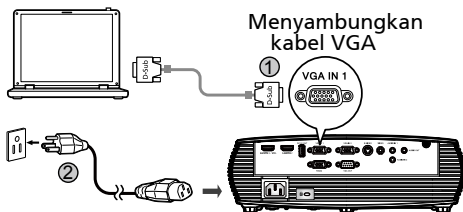

Menyambungkan kabel VGA

Menyambungkan kabel daya

Menyalakan Proyektor

Menghidupkan proyektor dan komputer

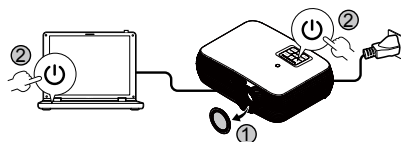

Buka tutup lensa



Pilih sumber input

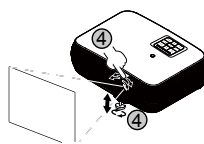

Sesuaikan fokus atau zoom

Mematikan Proyektor

Tekan tombol daya dua kali.

Български

Кратко ръководство за включване

Свързване към източник

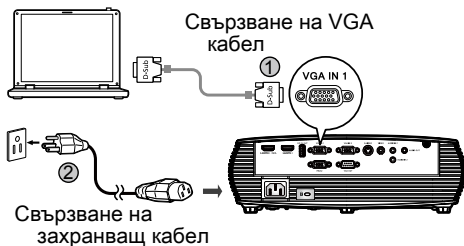

Включване на проектора

Включване на проектора и компютъра

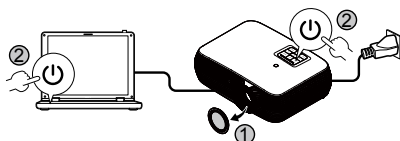

Махнете капачката от обектива

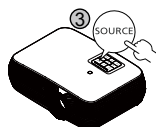

Изберете източник на входен сигнал

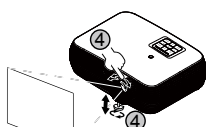

Регулиране на фокуса или мащабирането

Изключване на проектора

Натиснете бутона за изключване два пъти.

Čeština

Karta Rychlého Startu

Připojení ke zdroji

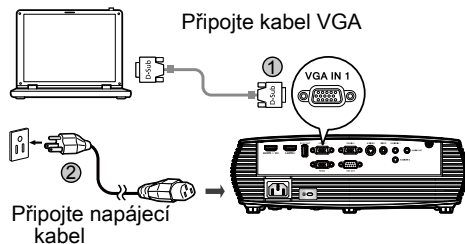

Zapnutí projektoru

Zapněte projektor a počítač

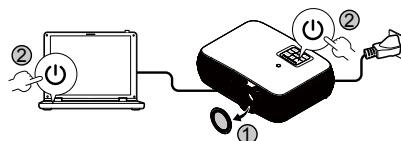

Sejmete veko objektivu



Vyberte vstupní zdroj

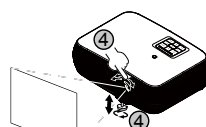

Upravte zaostření nebo zoom

Vypnutí projektoru

Stisknete dvakrát vypnac.

Hurtig Start

Tilslutning til en kilde

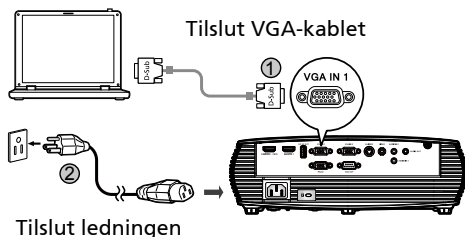

Opstart af projektor

Tænd projektoren og computeren

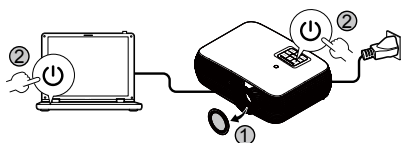

Fjern linsedækslet

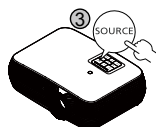

Vælg indgangskilden

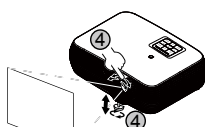

Juster fokus eller zoom

Slukning af projektoren

Tryk to gange på tænd-/slukknappen.

SCHELLSTART

Mit einer Quelle verbinden

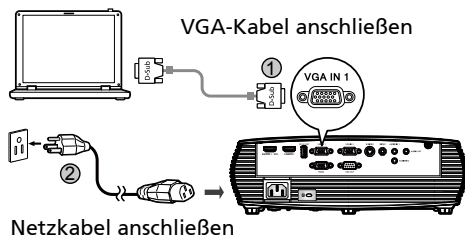

Einschalten des Projektors

Projektor und Computer einschalten

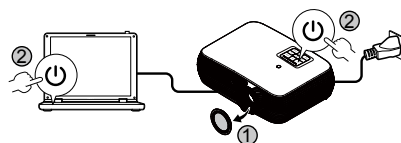

Entfernen Sie die
Objektivkappe



Eingangsquelle
wählen

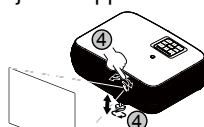

Scharfstellung
oder Zoom
anpassen

Ausschalten des Projektors

Drücken Sie zweimal auf die
Ein/Aus-Taste.

INICIO RÁPIDO

Conectar a una fuente

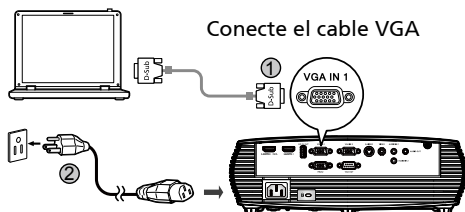

Encendido del proyector

Encienda el proyector y el equipo

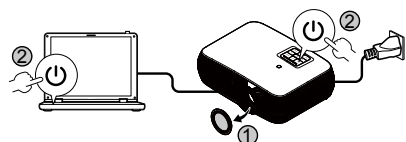

Quite la tapa de la lente

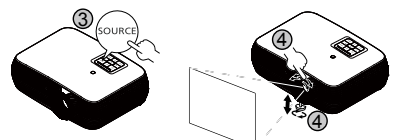

Seleccione la fuente de entrada

Ajuste el enfoque o zoom

Apagado del proyector

Pulse dos veces el botón de alimentación.

Σύντομη Έναρξη

Σύνδεση σε πηγή

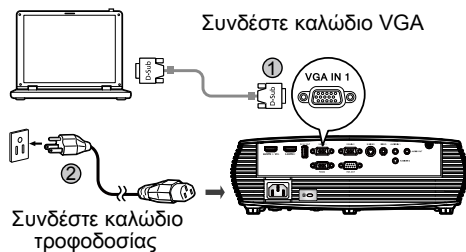

Άναμμα του Προβολέα

Ενεργοποιήστε τον προβολέα και τον υπολογιστή

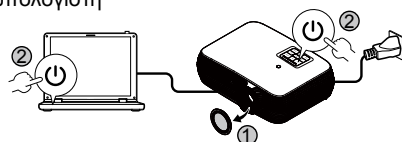

Αφαιρέστε το καπάκι του φακού

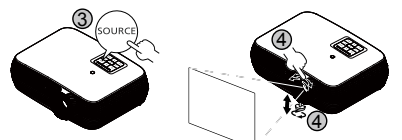

Επιλέξτε την πηγή εισόδου

Ρυθμίστε την εστίαση ή το ζουμ

Σβήσιμο του Προβολέα

Πατήστε δύο φορές το κουμπί τροφοδοσίας.

DÉMARRAGE RAPIDE

Connexion à une source

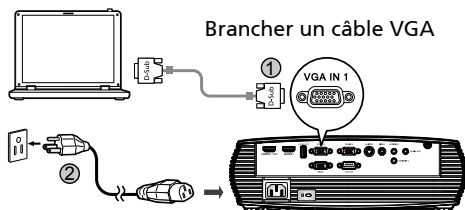

Brancher un câble VGA

Brancher le cordon secteur

Mise sous tension du projecteur

Mettez en marche le projecteur et l'ordinateur

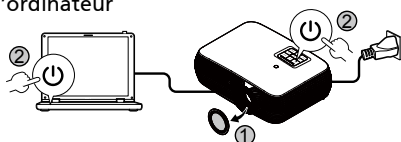

Retirez le protège-objectif

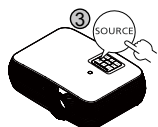

Sélectionnez la source en entrée

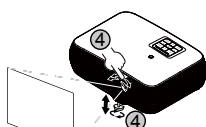

Faites la mise au point ou zoomez

Mise hors tension du projecteur

Appuyez le bouton d'alimentation deux fois.

Kratki pregled

Povezivanje s izvorom

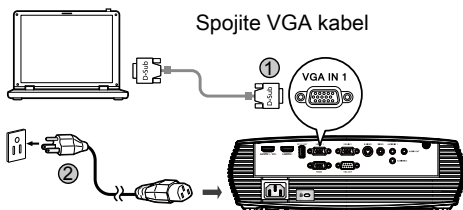

Spojite VGA kabel

Spojite kabel za napajanje

Uključivanje projektor

Uključite projektor i računal

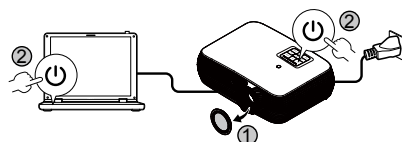

Uklonite poklopac leće

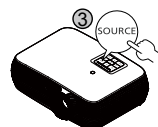

Odaberite ulazni izvor

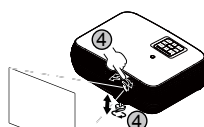

Prilagodba fokusa ili zuma

Isključivanje projektor

Dvaput pritisnite gumb za uključivanje.

GUIDA D'INSTALLAZIONE RAPIDA

Collegamento all'origine

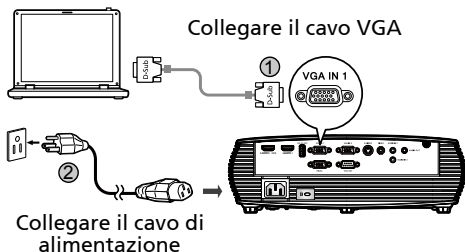

Accensione del proiettore

Accendere il proiettore e il computer

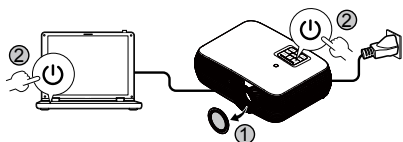

Rimuovere il coperchio
ell'obiettivo

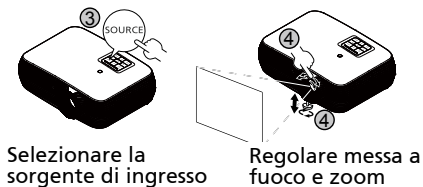

Spegnimento del proiettore

Premere due volte il pulsante di
accensione.

Gyorstelepítés

Csatlakozás forráshoz

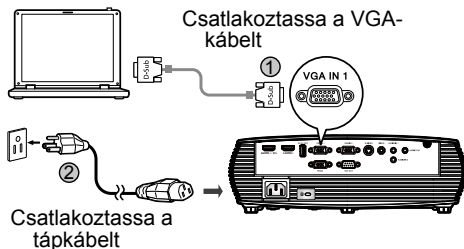

A projektor bekapcsolása

Kapcsolja be a kivetítőt és a számítógépet

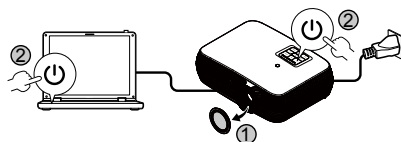

Vegye le a lencsevédő
kupakot

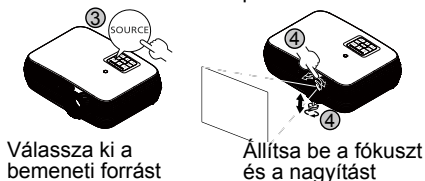

A projektor kikapcsolása

Nyomja meg kétszer az üzemkapcsolót.

Nederlands

Snelle Start

Aansluiten op een bron

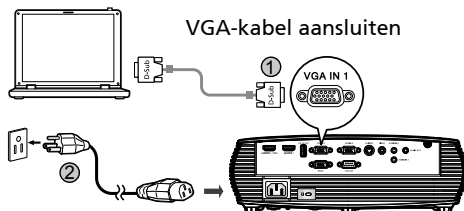

Stroomsnoer aansluiten

De projector inschakelen

De projector en de computer inschakelen

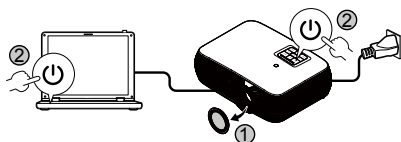

Verwijder de lenskap

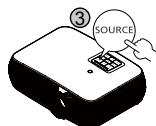

De inputbron selecteren

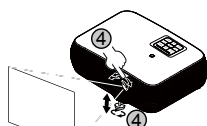

Scherpstelling of zoom aanpassen

De projector uitschakelen

Druk tweemaal op de aan/uit knop.

Norsk

Hurtigstart

Koble til en kilde

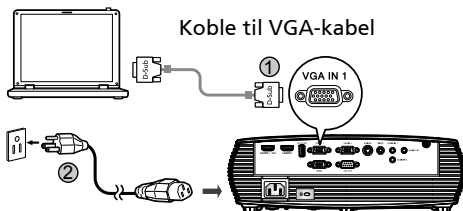

Koble til strømledningen

Slå på projektoren

Slå på projektoren og datamaskinen

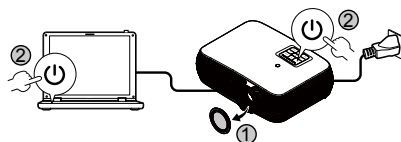

Ta av linsehetten



Velg inngangskilde

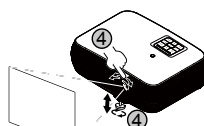

Juster fokus eller zoom

Slå av projektoren

Trykk to ganger på strømknappen.

INÍCIO RÁPIDO

Ligar a uma fonte de sinal

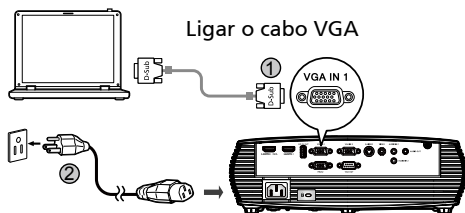

A activar o projector

Ligar o projector e o computador

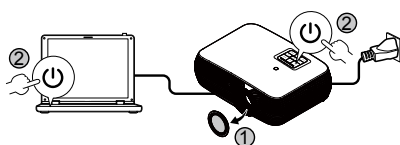

Tire a tampa da lente

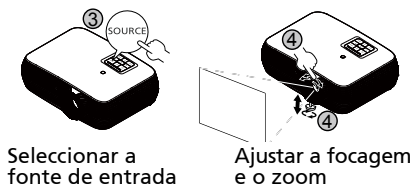

A desactivar o projector

Prima duas vezes o botão de energia.

SKRÓCONY PRZEWODNIK

Podłączanie do źródła

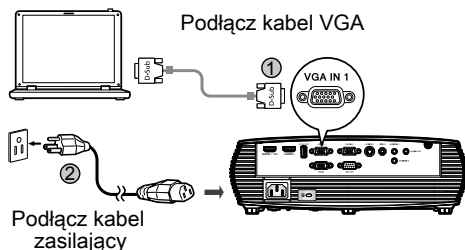

Włączanie projektora

Wyłącz projektor i komputer

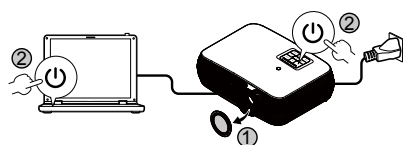

Zdjąć osłonę obiektywu

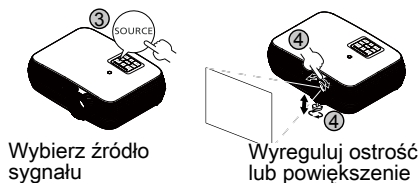

Wyłączanie projektora

Dwukrotnie nacisnąć przycisk zasilania.

КРАТКОЕ РУКОВОДСТВО

Подключение источников сигнала

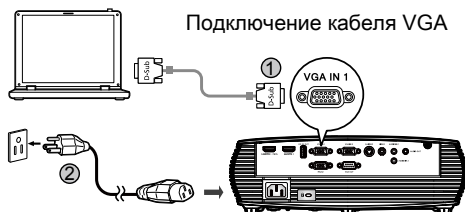

Подключение кабеля питания

Включение проектора

Включение проектора и компьютера

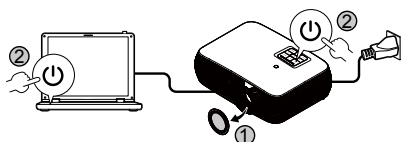

Снимите крышку с объектива

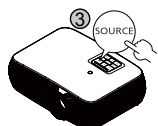

Выбор источника входного сигнала



Регулировка фокусного расстояния или масштаба

Выключение проектора

Дважды нажмите кнопку питания.

Ghid rapid

Conectarea la o sursă

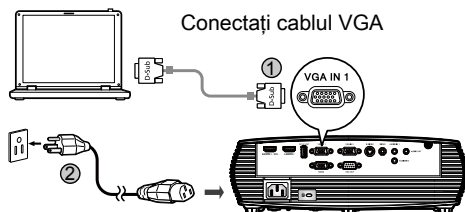

Conectați cablul de alimentare

Ponirea videoproiectorului

Porniți proiectorul și computerul

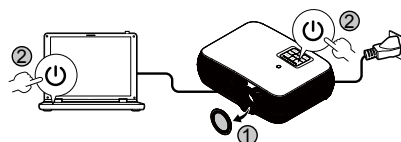

Îndepărtați capacul lentilei



Selecți sursa de intrare

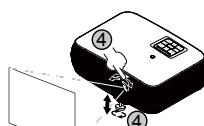

Ajustați focalizarea sau transfocarea

Oprirea videoproiectorului

Apasați butonul de pornire/oprire de două ori.

INŠTALÁCIA

Pripojenie k zdroju

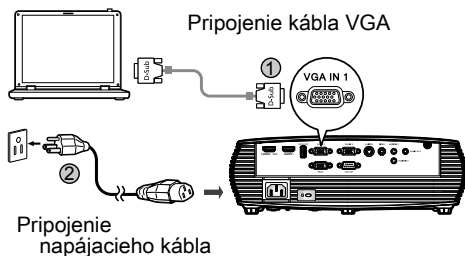

Zapnutie projektorja

Zapnúť projektor a počítač

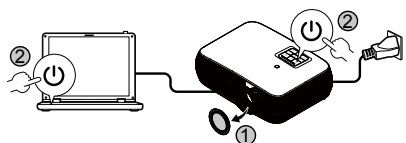

Odstráňte kryt šošovky

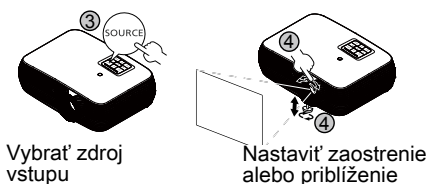

Vypnutie projektorja

Dvakrát stlačte tlačidlo napájania.

Kratka navodila

Priklučevanje vira

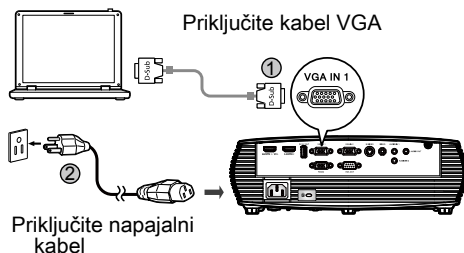

Vklop projektorja

Vklopite projektor in računalnik

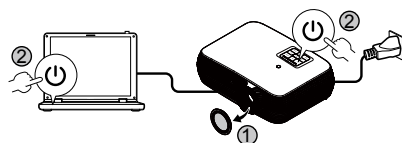

Odstranite pokrovček za lečo

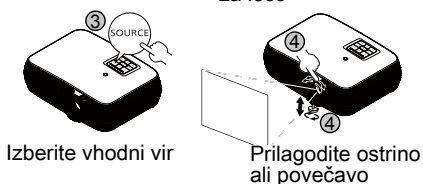

Izklop projektorja

Dvakrat pritisnite na gumb za vklop in izklop.

Brzi start

Povezivanje na izvor

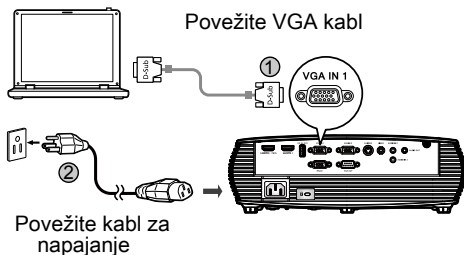

Uključivanje projektor

Uključite projektor i kompjuter

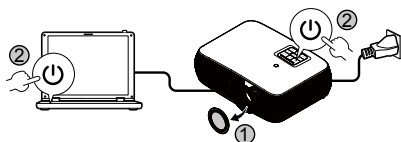

Uklonite poklopac za sočivo

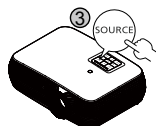

Odaberite izvor ulaza

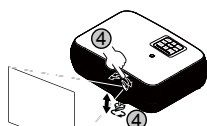

Podesite fokus ili zum

Isključivanje projektor

Pritisnite taster za napajanje dva puta

Pikakäynnistys

Yhdistäminen lähteeseen

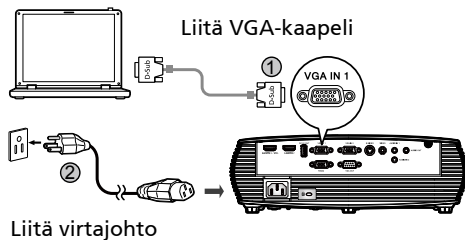

Kuvanheittimen käynnistäminen

Kytke projektori ja tietokone päälle

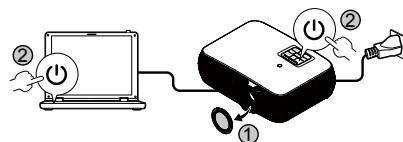

Poista objektiivisuojus



Valitse tulolähde

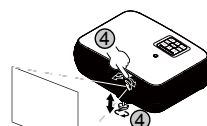

Säädä tarkennus tai zoomaa

Kuvanheittimen sulkeminen

Paina sähkökytkintä kahdesti.

SNABBSTART

Ansluta till en källa

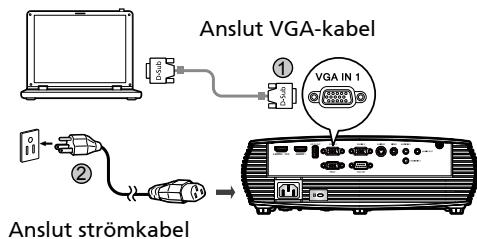

Starta projektorn

Slå på projektorn och datorn

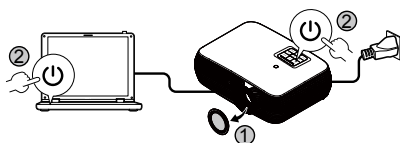

Stänga av projektorn

Tryck två gånger på power-knappen.

Hızlı Başlatma

Bir Kaynağa Bağlanma

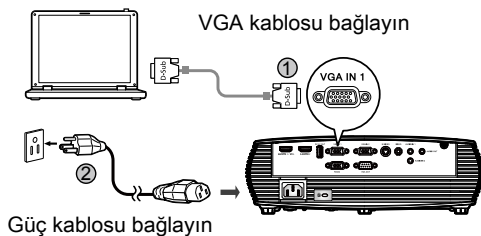

Projektörün Açılması

Projektörü ve bilgisayarı açın

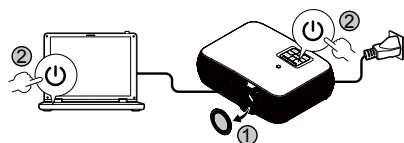

Projektörün Kapatılması

Güç düğmesine iki kez basın.

快速安裝卡

連接至一個訊號源

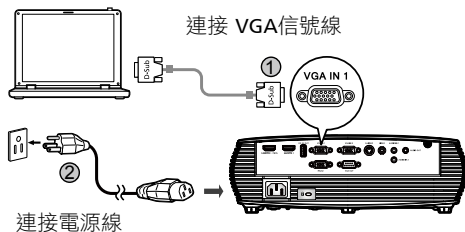

打開投影機電源

開啟投影機及電腦

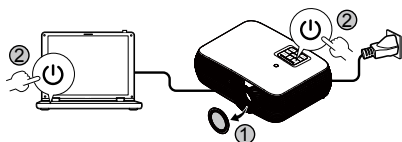

取下投影機鏡頭蓋

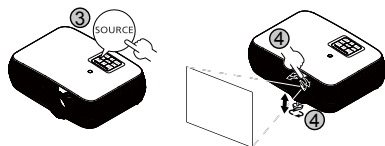

設定輸入信號源

調整焦距和縮放比例

關閉投影機電源

按兩次電源按鈕。

警語與注意事項

安全事項：

1. 請勿直視投影燈源，以免強光傷害您的眼睛。
2. 為預防火災及觸電意外，請勿將本產品淋到雨或置於潮濕處。

正確使用方法：

如長期未使用本產品，請從AC 插座拔掉電源插頭。更多安全事項及正確使用方法，請參考隨附光碟內之使用手冊。

快速启动卡

连接到输入源

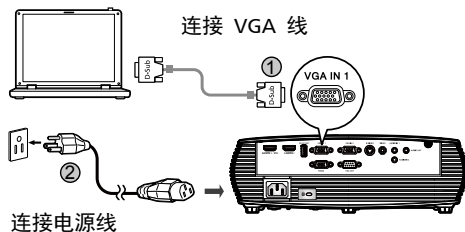

打开投影机电源

开启投影机及电脑

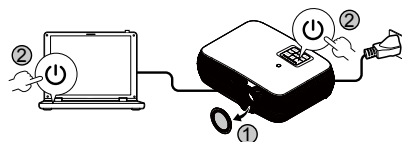

移去镜头盖

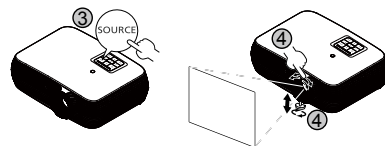

设定输入源

调整焦距和缩放

关闭投影机电源

按两次电源按钮。

日本語

クイックスタート

ソースに接続する

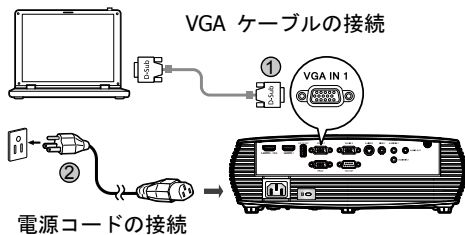

プロジェクタの電源を入れる

プロジェクターとコンピューターをオンにする

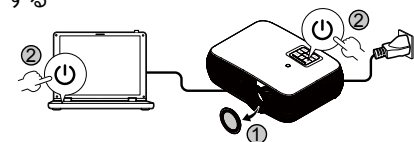

レンズキャップを外します

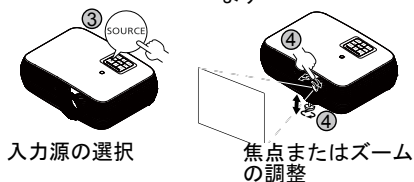

プロジェクタの電源を切る

電源ボタンを2回押します。

ไทย

คู่มือเริ่มต้นฉบับย่อ

การเชื่อมต่อไปยังแหล่งสัญญาณ

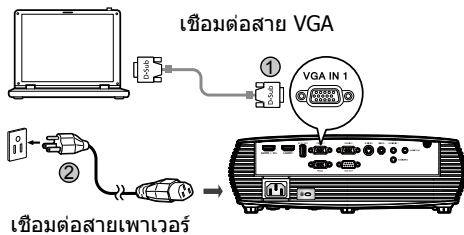

การเปิดโปรเจ็กเตอร์

เปิดโปรเจ็กเตอร์และคอมพิวเตอร์

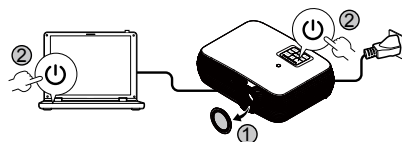

นำฝาเลนส์ออก

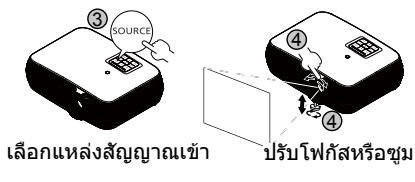

ปิดโปรเจ็กเตอร์

กดปุ่มเพาเวอร์สองครั้ง

한국어

빠른 시작

소스에 연결하기

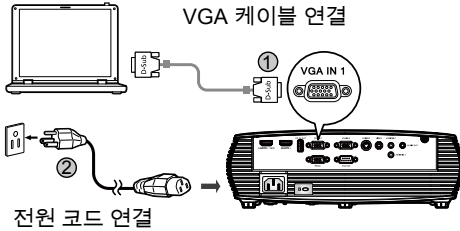

프로젝터 켜기

프로젝터와 컴퓨터 켜기

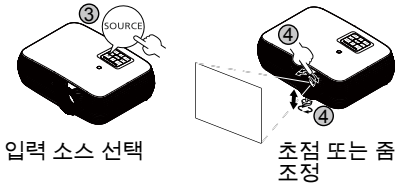

프로젝터 끄기

전원 버튼을 두 번 누릅니다.

Tiếng Việt

Khởi động nhanh

Kết nối với Nguồn tín hiệu

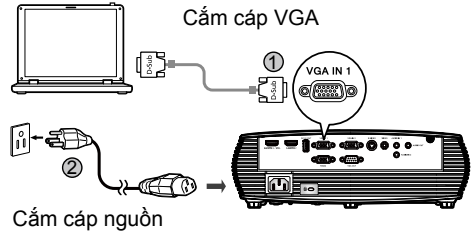

Bật nguồn máy chiếu

Bật máy chiếu và máy vi tính

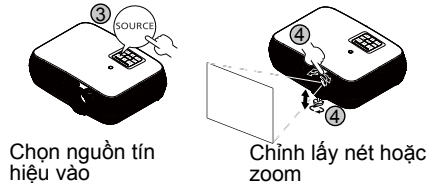
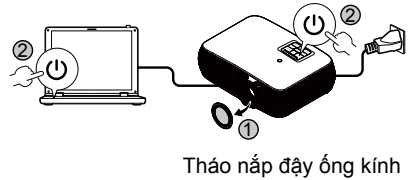

Tắt nguồn máy chiếu

Nhấn nút nguồn hai lần.

Швидкий старт

دليل سريع

Підключення до джерела

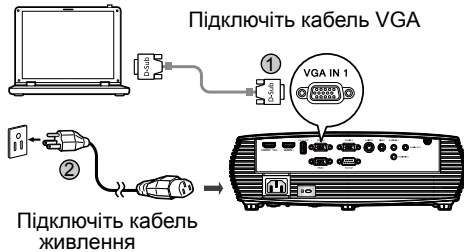

Увімкнення живлення проектора

Увімкніть проектор і комп'ютер

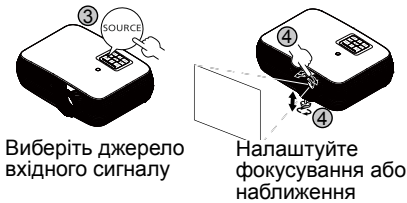

Вимкнення живлення проектора

Двічі натисніть кнопку живлення.

التوصيل بمصدر

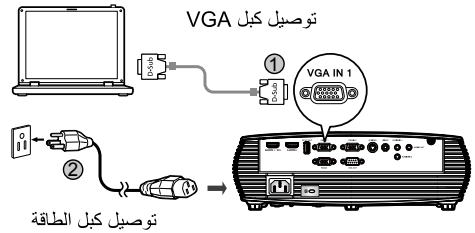

تشغيل جهاز العرض

تشغيل جهاز العرض والكمبيوتر

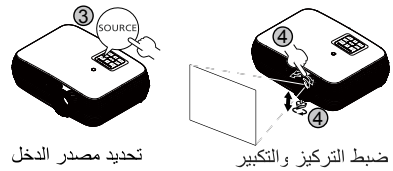
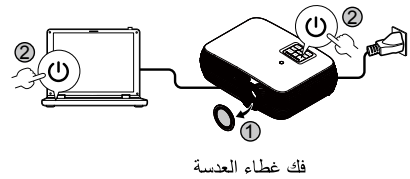

إيقاف تشغيل جهاز العرض

اضغط على زر الطاقة مرتين.

INSTALLATION

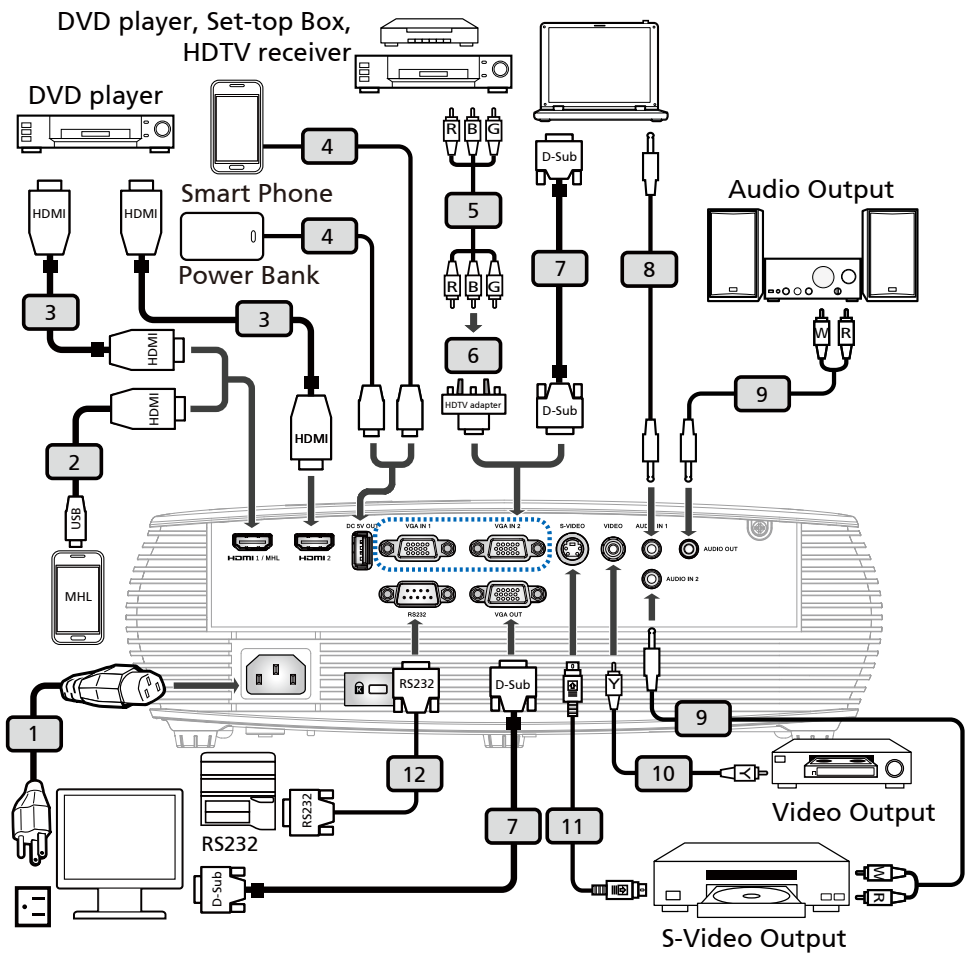

Note: Functions vary depending on model definition.

Consumo de Energia

En Operation: 264.47 Wh (264,47 Wh)
En modo de espera: 0.3931 Wh (0,3931 Wh)

SPECIFICATIONS

Projection system	DLP®
Resolution	800x600/SVGA, 1024x768/XGA, 1280x800/WXGA resolution
Computer compatibility	IBM PC and compatibles, Apple Macintosh, iMac and VESA standards: SXGA, XGA, VGA, SVGA, SXGA+, WXGA, WXGA+, WSXGA+
Video compatibility	NTSC (3.58/4.43), PAL (B/D/G/H/I/M/N), SECAM (B/D/G/K/L), HDTV (720p, 1080i, 1080p), EDTV (480p, 576p), SDTV (480i, 576i)
Aspect ratio	Auto, Full, 4:3, 16:9, L.Box
Displayable colors	1.07 billion colors
Optical zoom ratio	1.1X
Throw ratio	<ul style="list-style-type: none"> • SVGA / XGA: 1.94 ~ 2.16 (51" @ 2m) • WXGA: 1.54 ~ 1.72 (60" @ 2m)
Projection lens	<ul style="list-style-type: none"> • SVGA / XGA: F = 2.41 ~ 2.53, f = 21.85mm ~ 24.01mm, Manual Zoom & Focus • WXGA: F = 2.50 ~ 2.67, f = 21.86mm ~ 24.00mm, Manual Zoom & Focus
Projection screen size (diagonal)	<ul style="list-style-type: none"> • SVGA / XGA: 23" ~ 300" (58cm ~ 762cm) • WXGA: 27" ~ 300" (69cm ~ 762cm)
Projection distance	<ul style="list-style-type: none"> • SVGA / XGA: 1.0m ~ 11.8m (3.3' ~ 38.7') • WXGA: 1.0m ~ 10.0m (3.3' ~ 32.8')
Horizontal scan rate	15 - 100 kHz
Vertical refresh scan rate	24 - 120 Hz
Lamp type	220 W user-replaceable lamp
Keystone correction	±40 degrees
Audio	Internal speaker with 3 W x 1 output
Weight	2.65 Kgs (5.8lbs)
Dimensions (W x D x H)	314 mm X 223.4 mm X 98 mm (12.4" x 8.8" x 3.8")
Digital Zoom	2X
Power supply	AC input 100 - 240 V auto-switching power supply
Power consumption	<ul style="list-style-type: none"> • Normal mode: 260W ± 10% @ 110VAC • ECO mode: 200W ± 10% @ 110VAC • Standby mode < 0.5W
Operating temperature	0°C to 40°C / 32°F to 104°F
I/O connectors	<ul style="list-style-type: none"> • Power socket x1 • VGA IN x2 • VGA output x1 • HDMI x1 • HDMI/MHL x1 • 5V DC output x1 • 3.5 mm audio jack input x2 • 3.5 mm audio jack output x1 • S-Video x1 • Composite video x1 • RS232 x1

Note:

- The specifications listed above are subject to change without notice.
- Find manuals and other documents for your Acer product on the official Acer support website.